

VER	DESCRIPTION OF REVISIONS	DATE
A-0		2021/07/29
A-1	Door track change to S22-209	2023/10/23
A-2	Fan motor change to S17-223 Fan blade change to S17-224	2023/12/20
A-3	Fan change to S17-232	2023/12/29

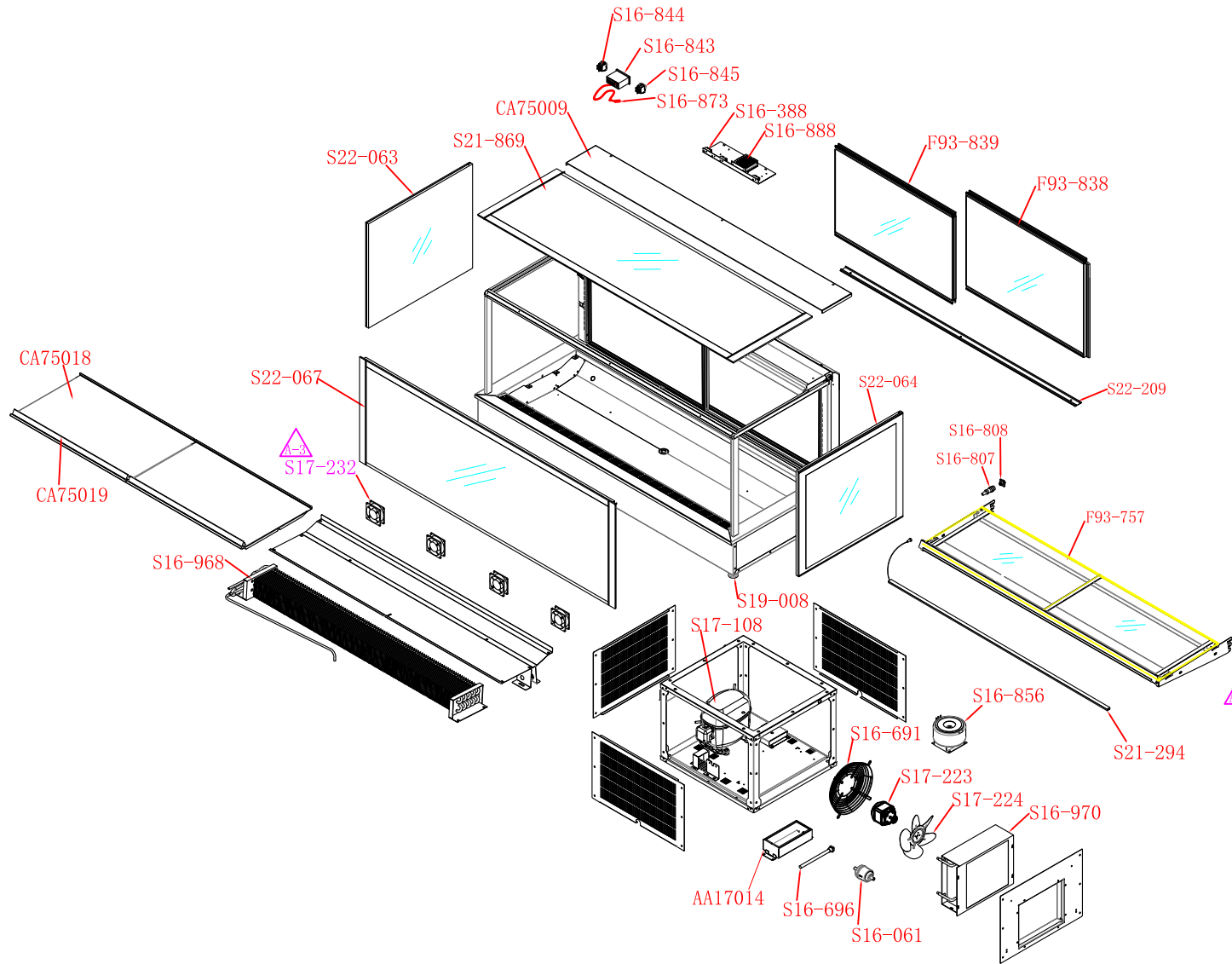

Cossiga F93-205 GGRF15R						
No	Part No	Name	Spec	Unit	QTY	Note
1	CA75009	Top cover		PCS	1	
2	AA17014	Evaporating pan with heater		PCS	1	
3	CA75018	Deck trays		PCS	2	
4	CA75019	Ticket strips of deck		PCS	2	
5	S16-061	Filter	DML-053S-3/8"	PCS	1	
6	S16-388	Terminal block	250VAC, 2.5MM2	PCS	3	
7	S17-223	Fan motor	MA4Q045-EF01-01/A37, 34W	PCS	1	
8	S17-224	Fan blade	Φ 254mm	PCS	1	
9	S16-691	Fan housing of motor	Φ 280-80	PCS	1	
10	S16-696	Heater	190W	PCS	1	
11	S16-807	Plug	WS16J3TQ-C, WEIPU, 3P	PCS	1	
12	S16-808	Socket	WS16K3Z-C, WEIPU, 3P	PCS	2	
13	S16-843	Thermostat	Dixell XR06CX-5NOC1 240V/50HZ	PCS	1	
14	S16-844	Power supply button	R-4-210-C5L-BR, Green	PCS	1	
15	S16-845	Lamp button	R-4-210-C5L-BG, yellow	PCS	1	
16	S16-856	Transformer	KT120-0400-1-01 240V-36V	PCS	1	
17	S16-873	Sensor	Dixell NG6 3M	PCS	1	
18	S16-888	Power supply	LRS-75-12, 12V/6A	PCS	1	
19	S16-968	Evaporator	O.D. 1185x95x175 (Φ 9, 52)	PCS	1	
20	S16-970	Condenser	350x288x122, Φ 7	PCS	1	
21	S17-108	Compressor	SECOP, SC15MNX/R290	PCS	1	
22	S17-232	Fan	CROWN, ECD0802502H 1P68	PCS	4	
23	S19-008	Plastic footing	M10*55	PCS	4	
24	S22-209	Door track		PCS	1	
25	S21-294	LED light	L=1300	PCS	2	
26	S22-063	Heated side glass - Left		PCS	1	
27	S22-064	Heated side glass - Right		PCS	1	
28	S21-869	Top glass		PCS	1	
29	S22-067	Front glass		PCS	1	
30	F93-757	Shelf assy		PCS	1	
31	F93-838	Rear Sliding Door - Left		PCS	1	
32	F93-839	Rear Sliding Door - Right		PCS	1	